

**NOTE: FIELD VERIFY ALL DIMENSIONS.
NOTIFY GENERAL CONTRACTOR OF ANY
DISCREPANCIES.**

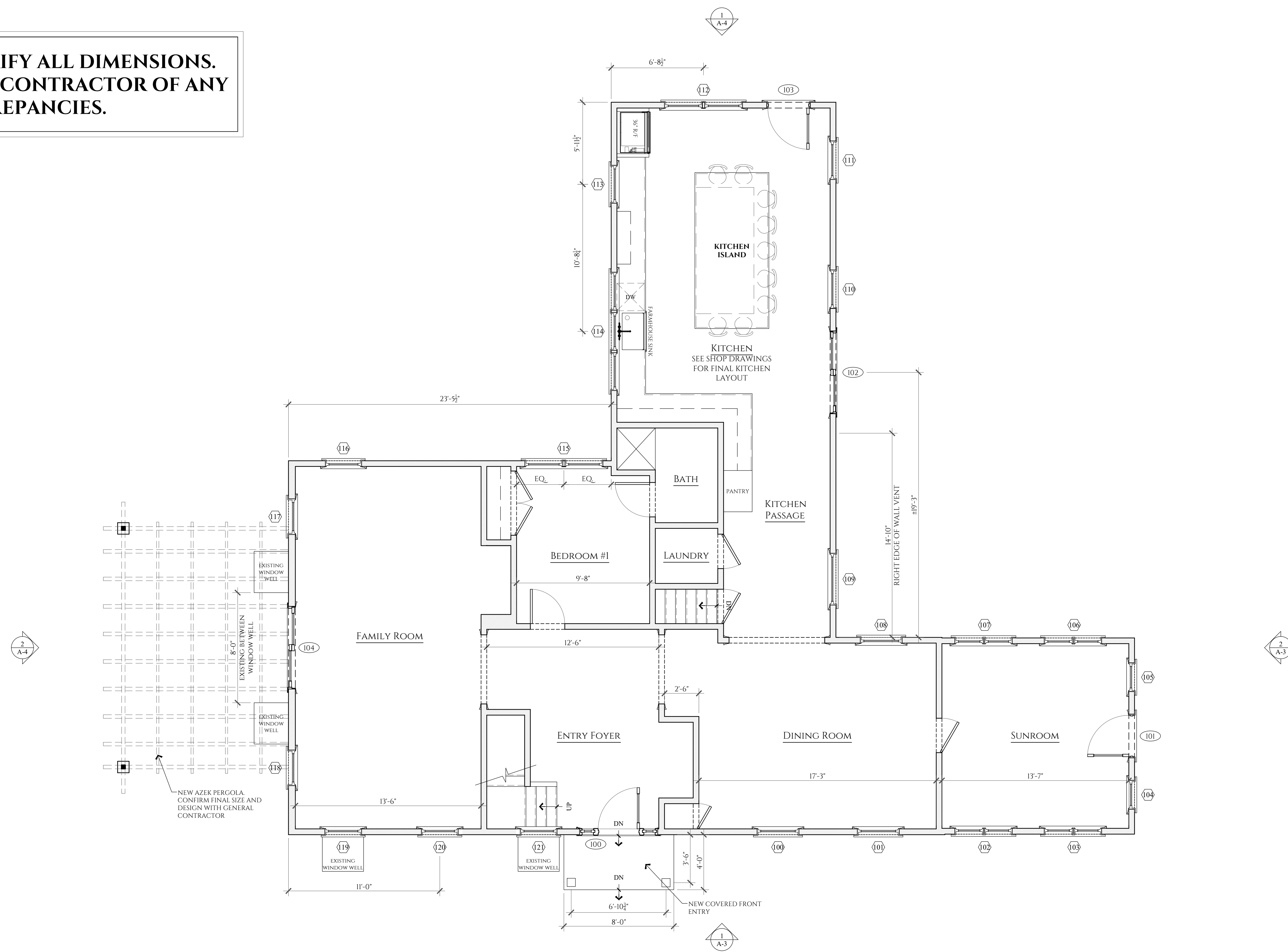

1 GUEST HOUSE - FIRST FLOOR PLAN
SCALE: 1/4" = 1'-0"

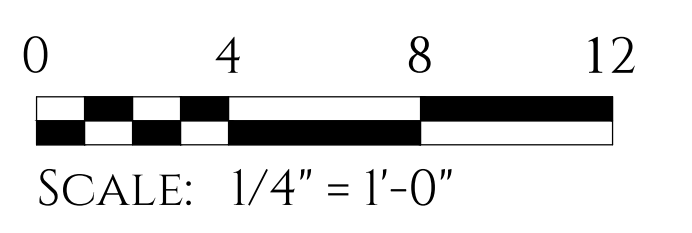

**NOTE: FIELD VERIFY ALL DIMENSIONS.
NOTIFY GENERAL CONTRACTOR OF ANY
DISCREPANCIES.**

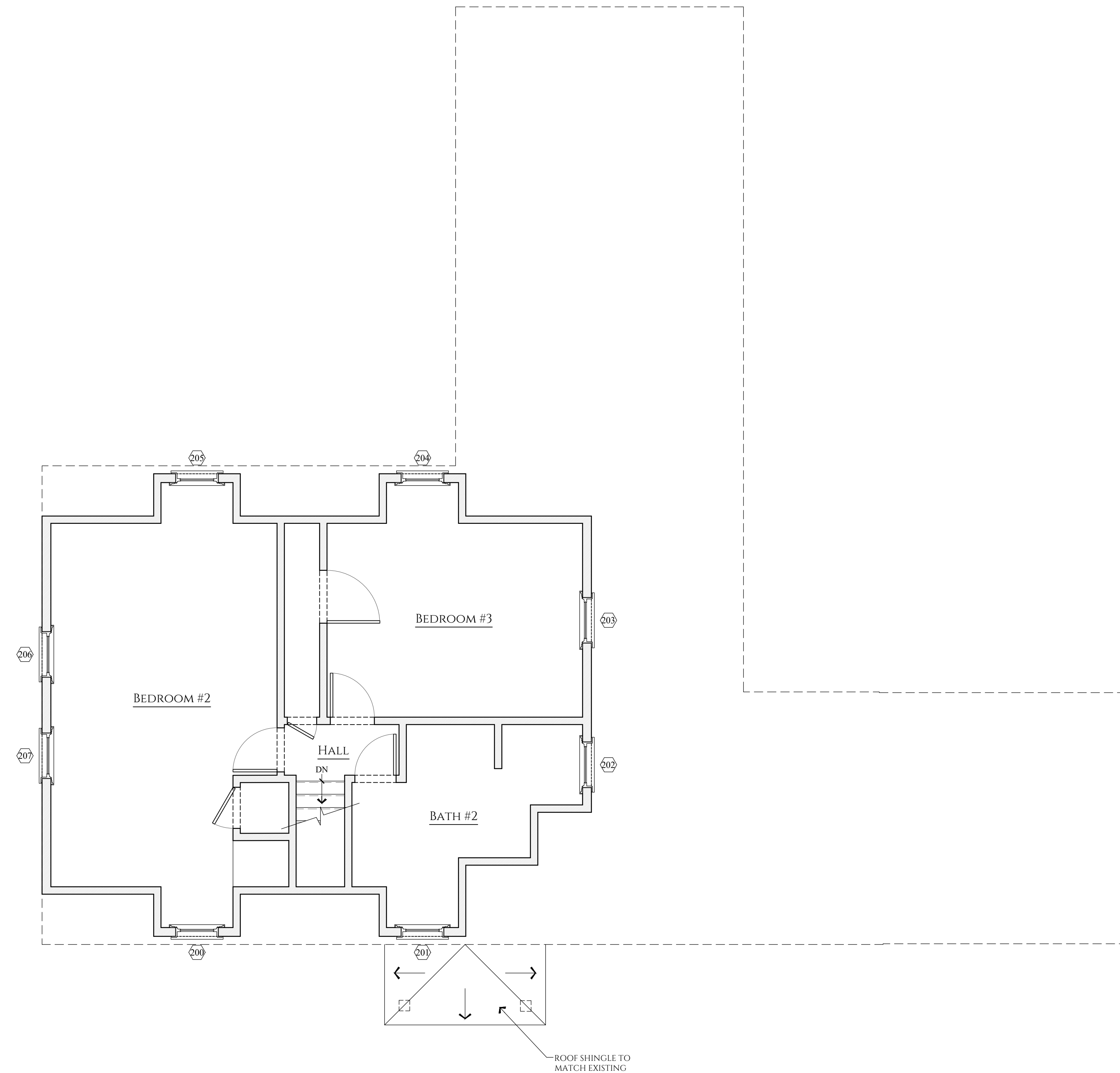

1 GUEST HOUSE - SECOND FLOOR PLAN
SCALE: 1/4" = 1'-0"

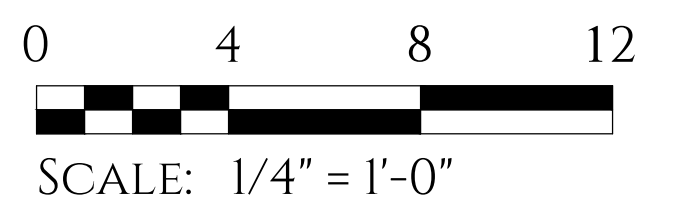



1 GUEST HOUSE - FRONT EXTERIOR ELEVATION
SCALE: 1/4"=1'-0"

**NOTE: FIELD VERIFY ALL DIMENSIONS.
NOTIFY GENERAL CONTRACTOR OF ANY
DISCREPANCIES.**



2 GUEST HOUSE - RIGHT SIDE EXTERIOR ELEVATION
SCALE: 1/4"=1'-0"

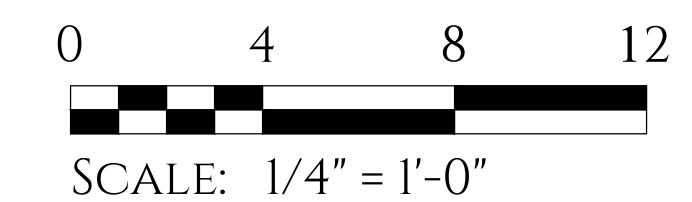



1 GUEST HOUSE - REAR EXTERIOR ELEVATION
SCALE: 1/4"=1'-0"

**NOTE: FIELD VERIFY ALL DIMENSIONS.
NOTIFY GENERAL CONTRACTOR OF ANY
DISCREPANCIES.**



2 GUEST HOUSE - LEFT SIDE EXTERIOR ELEVATION
SCALE: 1/4"=1'-0"

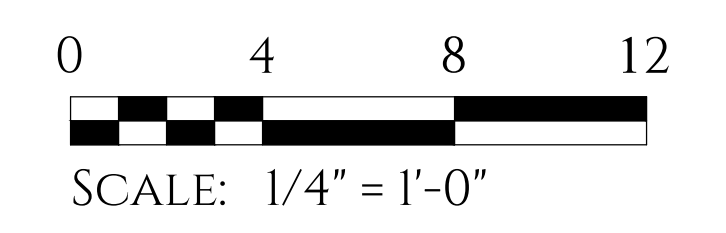

WINDOW TYPE:

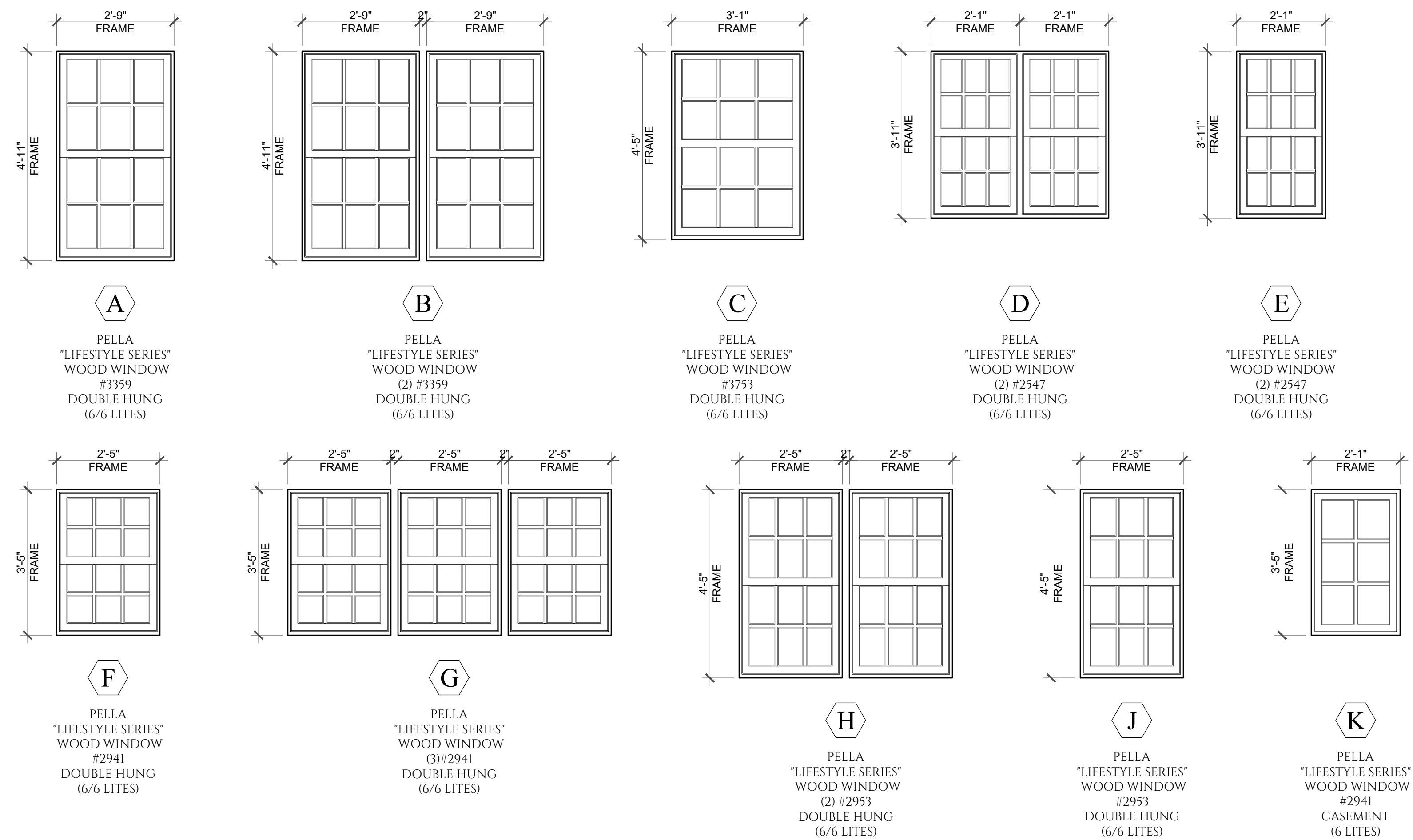

WINDOW SCHEDULE GENERAL NOTES:

ALL WINDOWS AND DOORS TO COMPLY WITH MASSACHUSETTS STATE RESIDENTIAL BUILDING CODE - 9TH EDITION.

ALL HEAD HEIGHTS AND JAMB DEPTHS ARE TO BE VERIFIED IN FIELD WITH ROUGH FRAMING OR EXISTING CONDITIONS AND COORDINATED WITH ARCHITECT

PROVIDE TEMPERED GLASS AT ALL DOORS AND AT WINDOWS WHERE REQUIRED BY CODE - SEE WINDOW SCHEDULE.

PROVIDE SHOP DRAWINGS FOR ALL CUSTOM WINDOWS
PELLA WINDOWS AND EXTERIOR DOORS

WINDOWS AND DOORS TO BE PELLA RESERVE TRADITIONAL SERIES WOOD WINDOWS WITH PRIMED INTERIOR AND EXTERIOR, UNLESS OTHERWISE NOTED.

SPECIFICATIONS:
6 9/16" EXTENSION JAMBS - VERIFY IN FIELD W/ EXISTING CONDITIONS
7/8" SDL WITH SPACER BAR
INSULATING CLEAR GLASS WITH LOW E II - ARGON FILLED

WINDOWS

PROVIDE BASIC UNIT WITH W8063 PROFILE PROJECTED SILL

HARDWARE: CLASSIC SPOON LOCKS - MATTE BLACK
SCREENS: STANDARD CHARCOAL FIBERGLASS - HALF SCREENS

FRENCH DOORS

BALDWIN RESERVE CLASSIC COLLECTION - MATTE BLACK
ADJUSTABLE HINGES - MATTE BLACK

ENERGY PERFORMANCE	U-VALUE	SHGC
DOUBLE HUNG WINDOWS:	.30	.26
CASEMENT WINDOWS:	.29	.24
FRENCH DOORS:	.29	.18

WINDOW SCHEDULE:

NUM.	TAG & TYPE	MANUF.	CODE	HEAD HT. A.F.F.	ROOM	WALL TYPE	NOTES
100	C DOUBLE HUNG	PELLA	#3753	±6'-6"	DINING ROOM	2X6 WOOD	NEW WINDOW IN EXISTING LOCATION
101	C DOUBLE HUNG	PELLA	#3753	±6'-6"	DINING ROOM	2X6 WOOD	NEW WINDOW IN EXISTING LOCATION
102	D DOUBLE HUNG	PELLA	(2)#2547	±6'-0"	SUNROOM	2X6 WOOD	NEW WINDOW IN EXISTING LOCATION
103	D DOUBLE HUNG	PELLA	(2)#2547	±6'-0"	SUNROOM	2X6 WOOD	NEW WINDOW IN EXISTING LOCATION
104	E DOUBLE HUNG	PELLA	#2547	±6'-0"	SUNROOM	2X6 WOOD	NEW WINDOW IN EXISTING LOCATION
105	E DOUBLE HUNG	PELLA	#2547	±6'-0"	SUNROOM	2X6 WOOD	NEW WINDOW IN EXISTING LOCATION
106	D DOUBLE HUNG	PELLA	(2)#2547	±6'-0"	SUNROOM	2X6 WOOD	NEW WINDOW IN EXISTING LOCATION
107	D DOUBLE HUNG	PELLA	(2)#2547	±6'-0"	SUNROOM	2X6 WOOD	NEW WINDOW IN EXISTING LOCATION
108	C DOUBLE HUNG	PELLA	#3753	±6'-6"	DINING ROOM	2X6 WOOD	NEW WINDOW IN EXISTING LOCATION
109	L FIXED	PELLA	#3525	±6'-8"	KITCHEN PASSAGE	2X6 WOOD	NEW WINDOW IN EXISTING LOCATION
110	J DOUBLE HUNG	PELLA	#2953	±6'-8"	KITCHEN	2X6 WOOD	NEW WINDOW IN EXISTING LOCATION
111	J DOUBLE HUNG	PELLA	#2953	±6'-8"	KITCHEN	2X6 WOOD	NEW WINDOW IN EXISTING LOCATION
112	H DOUBLE HUNG	PELLA	(2)#2953	±6'-8"	KITCHEN	2X6 WOOD	NEW WINDOW
113	F DOUBLE HUNG	PELLA	#2941	±6'-8"	KITCHEN	2X6 WOOD	NEW WINDOW
114	G DOUBLE HUNG	PELLA	(3)#2941	±6'-8"	KITCHEN	2X6 WOOD	NEW WINDOW
115	B DOUBLE HUNG	PELLA	(2)#3359	7'-0"	BEDROOM	2X6 WOOD	NEW WINDOW
116	A DOUBLE HUNG	PELLA	#3359	7'-0"	FAMILY ROOM	2X6 WOOD	NEW WINDOW IN EXISTING LOCATION
117	A DOUBLE HUNG	PELLA	#3359	7'-0"	FAMILY ROOM	2X6 WOOD	NEW WINDOW IN EXISTING LOCATION
118	A DOUBLE HUNG	PELLA	#3359	7'-0"	FAMILY ROOM	2X6 WOOD	NEW WINDOW IN EXISTING LOCATION
119	A DOUBLE HUNG	PELLA	#3359	7'-0"	FAMILY ROOM	2X6 WOOD	NEW WINDOW IN EXISTING LOCATION
120	A DOUBLE HUNG	PELLA	#3359	7'-0"	FAMILY ROOM	2X6 WOOD	NEW WINDOW
121	A DOUBLE HUNG	PELLA	#3359	7'-0"	ENTRY FOYER	2X6 WOOD	NEW WINDOW IN EXISTING LOCATION

NUM.	TAG & TYPE	MANUF.	CODE	HEAD HT. A.F.F.	ROOM	WALL TYPE	NOTES
200	K CASEMENT	PELLA	#2941	MATCH EXISTING	BEDROOM #2	2X6 WOOD	NEW WINDOW IN EXISTING LOCATION
201	K CASEMENT	PELLA	#2941	MATCH EXISTING	BATH #2	2X6 WOOD	NEW WINDOW IN EXISTING LOCATION
202	A DOUBLE HUNG	PELLA	#3359	MATCH EXISTING	BATH #2	2X6 WOOD	NEW WINDOW IN EXISTING LOCATION
203	A DOUBLE HUNG	PELLA	#3359	MATCH EXISTING	BEDROOM #3	2X6 WOOD	NEW WINDOW IN EXISTING LOCATION
204	K CASEMENT	PELLA	#2941	MATCH EXISTING	BEDROOM #3	2X6 WOOD	NEW WINDOW IN EXISTING LOCATION
205	K CASEMENT	PELLA	#2941	MATCH EXISTING	BEDROOM #2	2X6 WOOD	NEW WINDOW IN EXISTING LOCATION
206	A DOUBLE HUNG	PELLA	#3359	MATCH EXISTING	BEDROOM #2	2X6 WOOD	NEW WINDOW IN EXISTING LOCATION
207	A DOUBLE HUNG	PELLA	#3359	MATCH EXISTING	BEDROOM #2	2X6 WOOD	NEW WINDOW IN EXISTING LOCATION

DOOR TYPE:

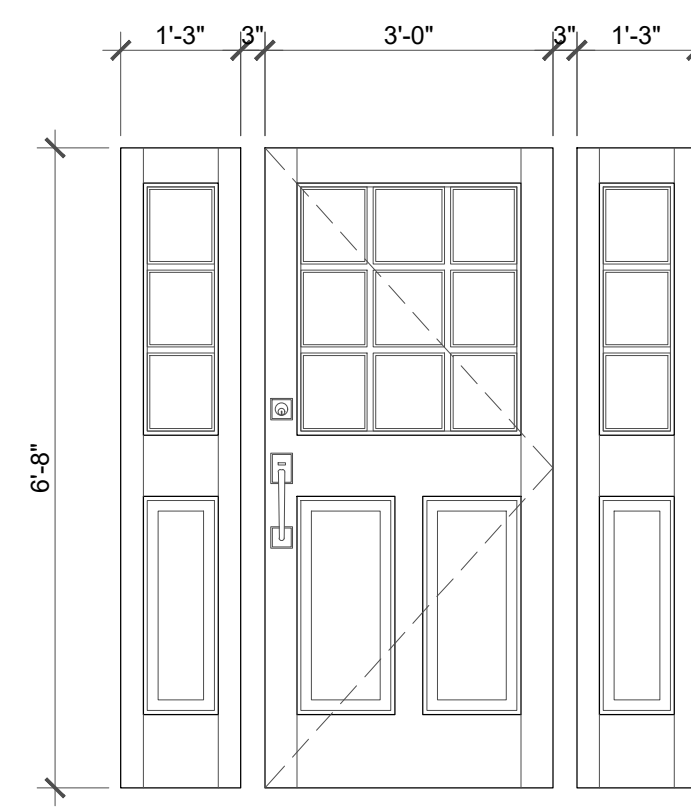

TYPE 1

SIMPSON EXTERIOR DOOR SIDELIGHTS
LOW-E ARGON FILLED GLASS
(PROVIDE SHOP DRAWING FOR
APPROVAL PRIOR TO ORDER)

U-FACTOR: .35 SHGC: .13

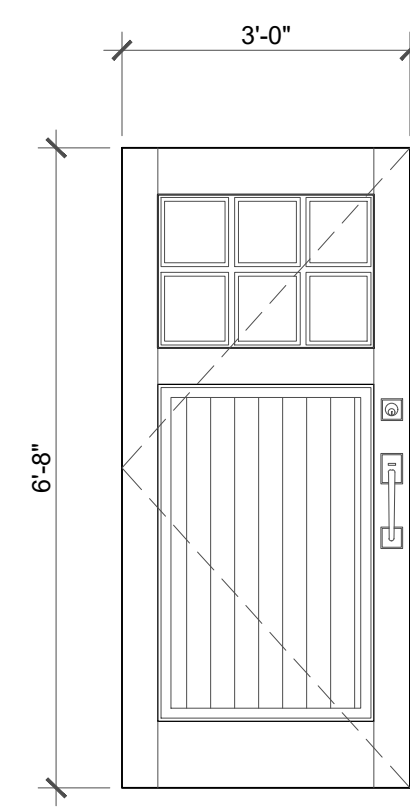

TYPE 2

EXTERIOR WOOD DOOR
(6 LITES)

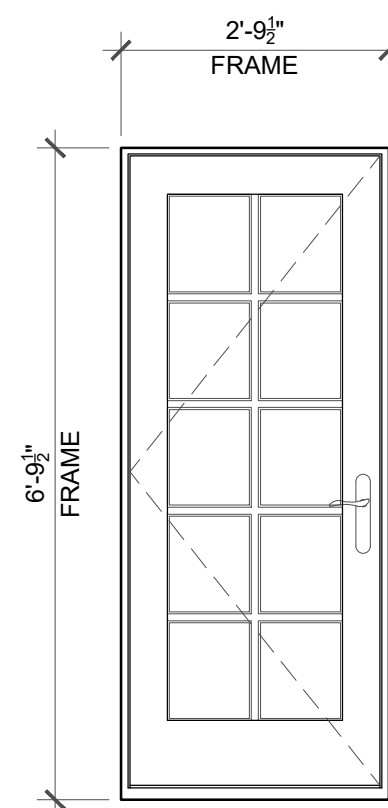

TYPE 3

PELLA
"LIFESTYLE SERIES"
FRENCH DOOR
#IF3482
W/ TEMPERED GLASS
(12 LITES)

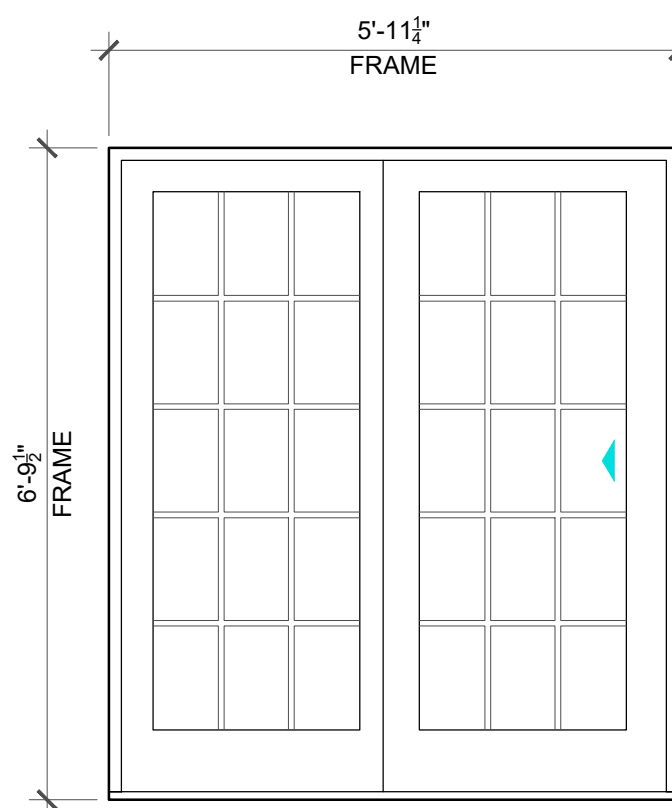

TYPE 4

PELLA
"LIFESTYLE SERIES"
WOOD WOOD SLIDING
PATIO DOORS
#7282

DOOR SCHEDULE:

	DOOR TAG	DOOR TYPE	FROM	TO	QTY.	OPENING SIZE			MATERIAL	FINISH	HDW SET	NOTES
						W	H	T				
FIRST FLOOR	100	1	EXTERIOR	ENTRY FOYER	SINGLE W/ SIDELITES	3'-0"	6'-8"	2 1/4"	WD/GLASS	PTD.	1	INSULATED DOOR WITH SIDELITES
	101	2	EXTERIOR	SUNROOM	SINGLE	3'-0"	6'-8"	2 1/4"	WD/GLASS	PTD.	1	INSULATED DOOR WITH SIDELITES
	102	4	EXTERIOR	KITCHEN	DOUBLE	5'-11 1/2" (FRAME)	6'-9 1/2" (FRAME)	2 1/4"	WD/GLASS	PTD.		
	103	3	EXTERIOR	KITCHEN	SINGLE	2'-9 1/2" (FRAME)	6'-9 1/2" (FRAME)	2 1/4"	WD/GLASS	PTD.	6	
	104	4	EXTERIOR	FAMILY ROOM	DOUBLE	5'-11 1/2" (FRAME)	6'-9 1/2" (FRAME)	2 1/4"	WD/GLASS	PTD.		

DOOR HARDWARE NOTES:

1. TYPICAL EXTERIOR DOOR HARDWARE SET
 - A. BALDWIN LOCK-SETS: CYLINDERS KEYED ALIKE, MORTISED STYLE WITH LATCH BOLT AND DEAD BOLT. BLACK. CONTRACTOR SHALL INSTALL LOCKSETS.
 - B. HINGES (BLACK): FULLY MORTISED 4-1/2" BY 4-1/2" FIVE KNUCKLE, BALL BEARING WITH NON-REMOVABLE PINS.
 - C. WEATHER STRIPPING: COMPRESSIBLE NEOPRENE WITH METAL RETAINER.
2. TYPICAL INTERIOR SINGLE DOOR PRIVACY HARDWARE SET:
 - A. BALDWIN PRIVACY LOCK-SETS: MATTE BLACK
 - B. HINGES (BLACK): FULLY MORTISED FIVE KNUCKLE, LOOSE PINS.
 - C. HANDLES AND ESCUTCHEONS TO BE SELECTED BY OWNER FROM BALDWIN CATALOGUE, PURCHASED AND INSTALLED BY CONTRACTOR.
3. TYPICAL INTERIOR SINGLE DOOR PASSAGE HARDWARE SET:
 - A. BALDWIN PASSAGE LOCK-SETS: MATTE BLACK
 - B. HINGES (BLACK): FULLY MORTISED FIVE KNUCKLE, LOOSE PINS.
 - C. HANDLES AND ESCUTCHEONS TO BE SELECTED BY OWNER FROM BALDWIN CATALOGUE, PURCHASED AND INSTALLED BY CONTRACTOR.
4. TYPICAL INTERIOR "PAIRED" DOOR PASSAGE HARDWARE SET:
 - A. BALDWIN PASSAGE LOCK-SETS: MATTE BLACK
 - B. HINGES (MATTE BLACK): FULLY MORTISED FIVE KNUCKLE, LOOSE PINS.
 - C. HANDLES AND ESCUTCHEONS TO BE SELECTED BY OWNER FROM BALDWIN CATALOGUE, PURCHASED AND INSTALLED BY CONTRACTOR.

DOOR HARDWARE NOTES:

5. TYPICAL INTERIOR "SINGLE" POCKET DOOR HARDWARE SET:
 - A. CARRIERS & TRACK: STANLEY SERIES I750. DOOR HARDWARE WITH WHEEL CARRIERS, ALUMINUM TRACK, DOOR GUIDE AND BUMPER STOPS PURCHASED AND INSTALLED BY CONTRACTOR.
 - B. LOCK-SETS AND HANDLES TO BE SELECTED AND PURCHASED BY OWNER FROM THE ANGLO AMERICAN BRASS CATALOGUE (SAN JOSE, CA), AND INSTALLED BY CONTRACTOR.
 - C. ALL OTHER HARDWARE SHALL BE PURCHASED & INSTALLED BY CONTRACTOR.
6. TYPICAL EXTERIOR "PAIRED" OR SINGLE FRENCH DOOR HARDWARE SET
 - A. PELLA: CLASSIC COLLECTION - MATTE BLACK
 - B. ADJUSTABLE HINGES - MATTE BLACK
7. EXTERIOR SCREENED DOOR HARDWARE SET:
 - A. T.B.D.
8. CARRIAGE HOUSE DOOR HARDWARE SET:
 - A. LOCKS & HANDLES: BLACK IRON, RENOVATOR'S SUPPLY (OR EQUAL). STYLE TO BE APPROVED BY ARCHITECT AND OWNER PRIOR TO ORDERING.
 - B. HINGES: BLACK IRON STRAP HINGES AND PINTLE FROM RENOVATOR'S SUPPLY (OR EQUAL).
 - C. WEATHERSTRIPPING: COMPRESSIBLE NEOPRENE WITH METAL RETAINER.
9. EXTERIOR DUTCH DOOR HARDWARE SET:
 - A. T.B.D.
10. TYPICAL INTERIOR DUMMY DOOR HANDLE SET
 - A. BALDWIN DUMMY DOOR SETS: MATTE BLACK
 - B. HINGES (BLACK): FULLY MORTISED FIVE KNUCKLE, LOOSE PINS.
 - C. HANDLES AND ESCUTCHEONS TO BE SELECTED BY OWNER FROM BALDWIN CATALOGUE, PURCHASED AND INSTALLED BY CONTRACTOR.